

See pg 71 + D-3-245-4 D-7-49

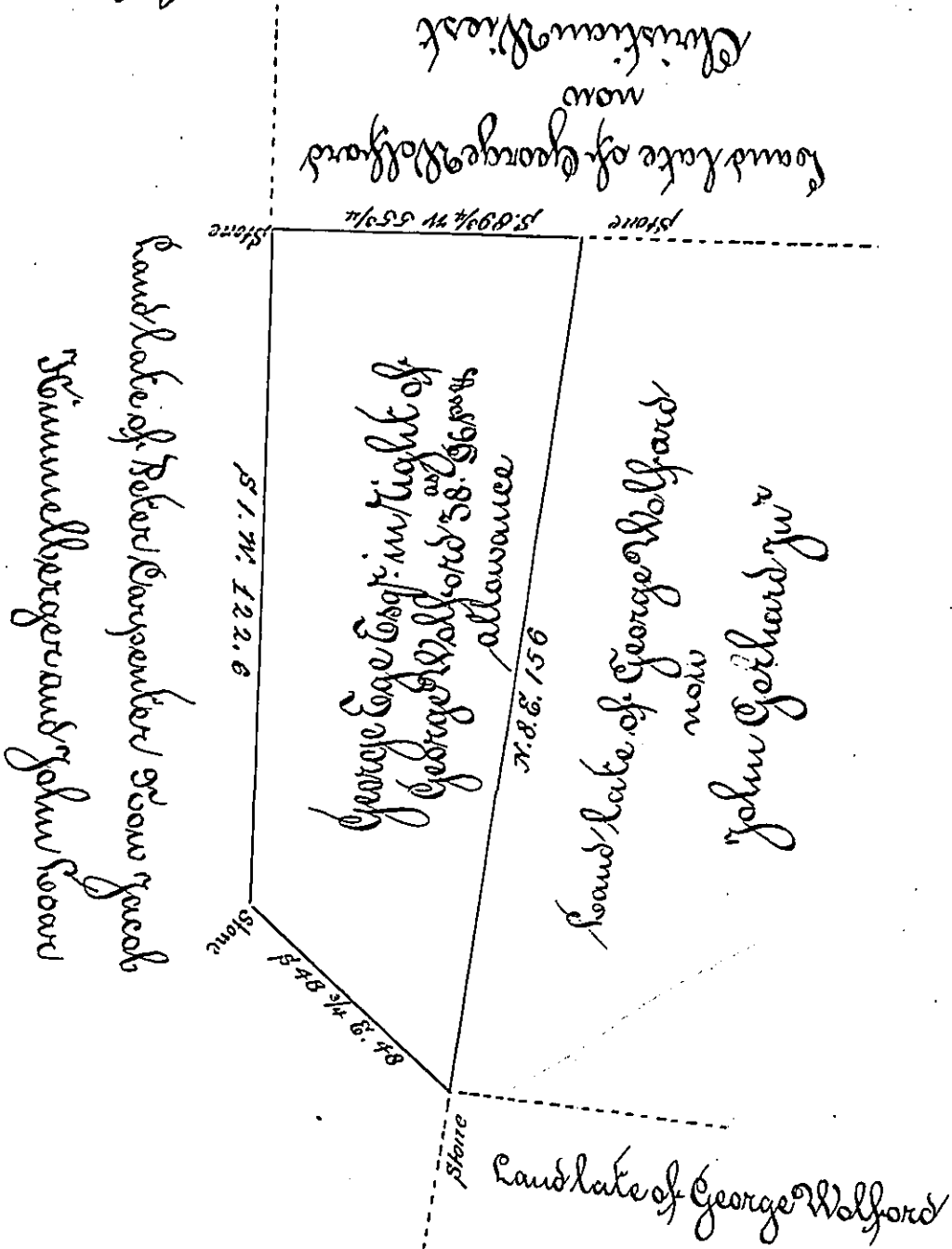

A Draught of a piece or Tract of Land situate in Locust Township Lancaster County containing 38⁹⁶/₁₀₀ & 96^{1/2} & the usual Allowance of Six P. Cent for Roads &c. surveyed the 17th Day of December A.D. 1807. for George Edge Esq. in right of George Wolford (It being part of a larger Tract of 143⁹⁵/₁₀₀ & 125^{1/2} & allowance surveyed unto the said George Wolford by Virtue of a Warrant Dated the 23rd Day of March A.D. 1749/50

To Samuel Cochran Esq.
Surveyor General

W. H. Beaman D.D.
and Saul Emswinger D.Dr.

IN TESTIMONY that the above is a copy of the original remaining on file in the Department of Internal Affairs of Pennsylvania, made conformably to an Act of Assembly approved the 16th day of February, 1833, I have hereunto set my Hand and caused the Seal of said Department to be affixed at Harrisburg, this first day of August 1899.

James W. Potts
Secretary of Internal Affairs.